

1215R Coreless Brush Motor

Coreless Brush Motors

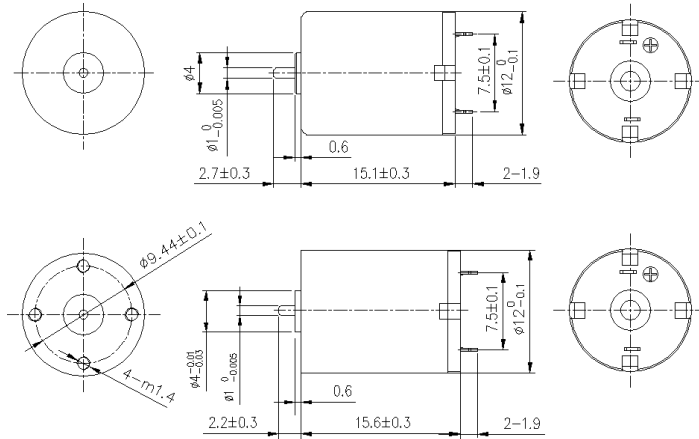

Typical Applications: RC servo, Aircraft model, Door Lock, Pan&Tilt

| 电机参数 (Motor data) | | 06A | 04A | 01A | 21A | 18A | 02A |
|-------------------------------------|----------|-------|-------|-------|-------|-------|-------|
| 额定电压下数值 (Values at nominal voltage) | | | | | | | |
| 1 额定电压 (Nominal voltage) | V | 4.5 | 4.5 | 6 | 7.4 | 7.4 | 8 |
| 2 空载转速 (No load speed) | rpm | 19500 | 15200 | 22900 | 27460 | 20000 | 32300 |
| 3 空载电流 (No load current) | mA | 40 | 40 | 40 | 50 | 30 | 60 |
| 4 额定转速 (Nominal speed) | rpm | 15300 | 11400 | 19250 | 23340 | 16300 | 27850 |
| 5 额定转矩 (最大连续转矩) (Nominal torque) | mNm | 0.8 | 0.8 | 0.8 | 0.8 | 0.8 | 0.8 |
| 6 额定电流 (最大连续电流) (Nominal current) | A | 0.4 | 0.34 | 0.36 | 0.36 | 0.25 | 0.4 |
| 7 堵转转矩 (Stall torque) | mNm | 4.04 | 3.2 | 5.1 | 5.3 | 4.48 | 5.7 |
| 8 堵转电流 (Stall current) | A | 1.88 | 1.16 | 2.07 | 2.13 | 1.3 | 2.48 |
| 9 最大效率 (Max efficiency) | % | 75 | 71 | 77 | 75 | 75 | 74 |
| 电机常数 (Motor constant) | | | | | | | |
| 10 相间电阻 (Terminal resistance) | Ω | 2.4 | 3.87 | 2.9 | 3.48 | 5.7 | 3.23 |
| 11 转距常数 (Torque constant) | mNm/A | 2.16 | 2.77 | 2.45 | 2.52 | 3.46 | 2.32 |
| 12 速度常数 (Speed constant) | rpm/V | 4333 | 3378 | 3817 | 3711 | 2703 | 4038 |

其他特性参数 Other characteristic parameters

- 13 环境温度范围 (Ambient temperature) -10~40°C
- 14 绕组最高允许温度 (Max permissible winding temperature) 80°C
- 15 最高允许转速 (Max permissible speed) 35000rpm
- 16 电极磁极对数 (Number of the pole pairs) 1
- 17 换向器片数 (Number of the commutator segments) 5
- 18 电机质量 (Weight) 6.73g

01A电机曲线图 motor curve

